

Heber City Community Reinvestment Agency (CRA) Project Cut Sheet

Project Title:

25 North Main Improvements (County Adm. Building Parcel)

Project Category

Buildings and Amenities

Project Timing

Fiscal Year Start =	TBD
Fiscal Year End =	TBD

Project Location

Hwy 40 and 25 North Main (County Admin Building Parcel) Parcel
Id: 00-0005-0380
Serial: OHE-0642-0-090-035

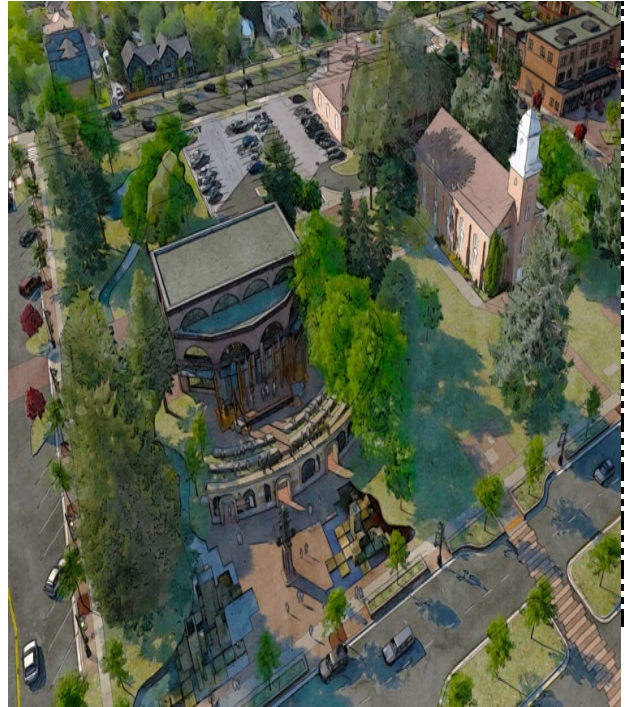
Relevant Graphic Detail**Strategic Relevance**

Envision Heber 2050; Envision Central Heber; Heber City Council Budget and Policy Priorities FY '25. The attached picture was generated as part of the Envision Central Heber initiative.

Project Description

This project is of strategic important to Heber City's downtown transformation. The lot sits adjacent to the historic Tabernacle and Social Hall buildings. The lot also serves as the north "book end" to the mid-block pedestrian alley which begins on 200 South and ends near Center Street. Strategic planning done in this area identifies need for more conference space, meeting space for small to mid-size retreats/seminars/conferences. Initial discussion includes replacing the County Administration Building with a larger replica of the historic court house which once stood on this site. Visioning also includes day-lighting the underground creek, and providing additional parking.

Project Cost Estimate

TBD. Additional planning is required to finalize plans for this area. To this end, \$100k has been included in the CRA budget to complete the project planning for this lot.

Project Funding Source

TBD. Funding is likely to come from multiple sources: CRA, General Fund, Bonding, and Private Partnerships.

Project Sequencing and Phasing

This project will follow the purchase of the lot, completion of planning process and finalization of funding.